

SIEMENS

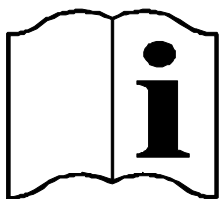

RDG400KN

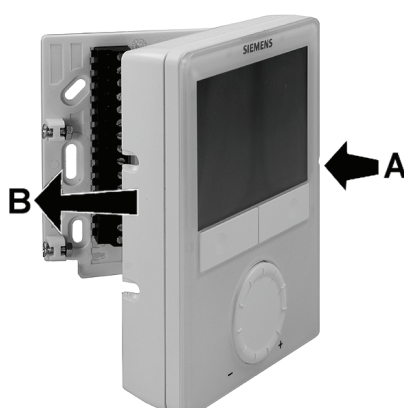
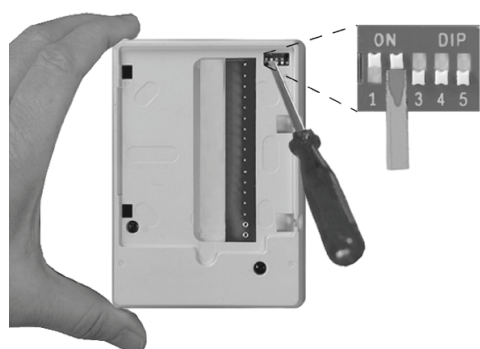
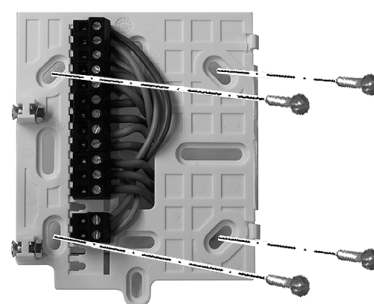
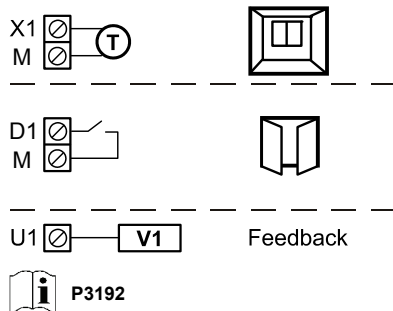
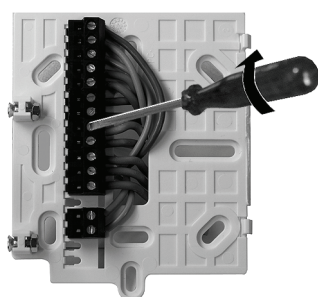
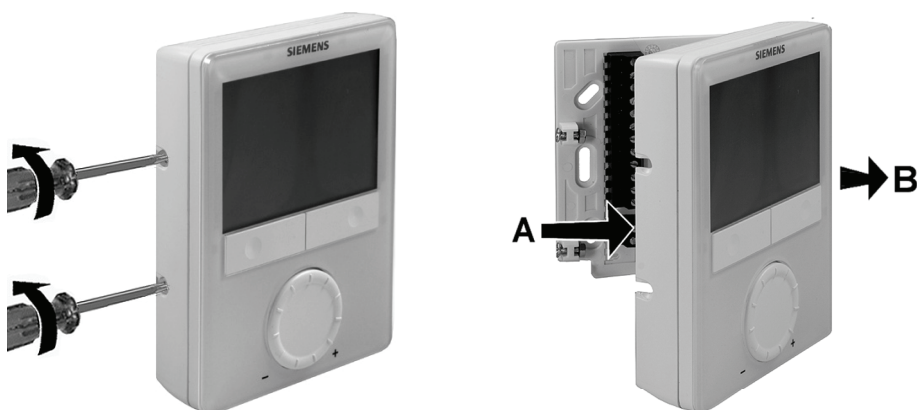
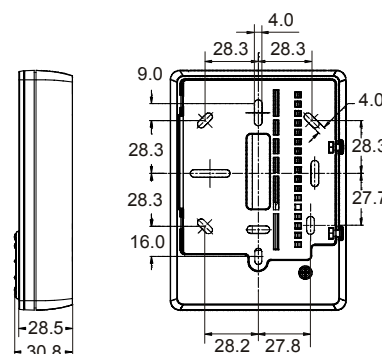
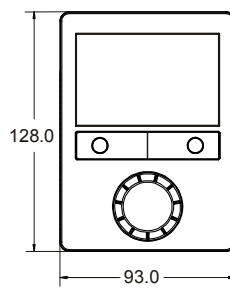
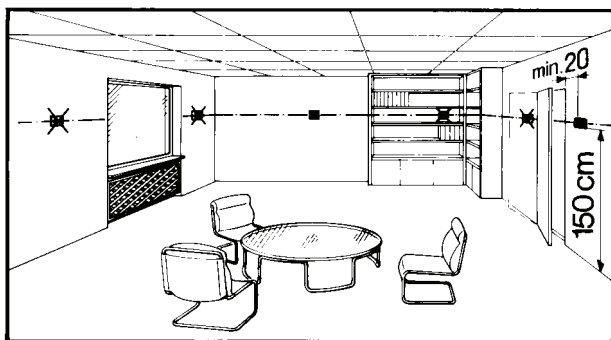

- 1) ① ④
- 2) **a** Outputs → DC 0...10 V / DC 10...0 V / 3-pos
- 3) and
- 4)
- 5) G, G0 / 24 VAC: → P01...Pn

a Outputs

DC 10..0 V DIP 4 ON

DC 0..10 V DIP 4 OFF

3-pos

VAV Y10 ▲Y1/▼Y2

① Single duct

ON OFF

1 2 3 4 5

ON OFF

1 2 3 4 5

ON OFF

1 2 3 4 5

a Outputs

Y10 DC 10..0 V DIP 4 ON

DC 0..10 V DIP 4 OFF

VAV V1

VAV V1

V2

Y1 / Y2

V2 2-pos (PWM) Y1

V2 3-pos ▲Y1/▼Y2

VAV V1 3-pos ▲Y1/▼Y2

② Single duct & el. heater

ON OFF

1 2 3 4 5

ON OFF

1 2 3 4 5

ON OFF

1 2 3 4 5

KNX Programming mode

→ P3182

	en	de	fr	it	es	nl	tr
①	Single duct	Einkanal	Monogaine	Monocondotto	Un conducto	Eénkanaals	Tek kanal
②	Single duct & el. heater	Einkanal & elektr. Heizung	Monogaine & chauffage électrique	Monocondotto & batteria elettrica di riscaldamento	Un conducto & batería eléctrica	Eénkanaals + elektr. verwarmers	Tek kanal & Elk ısıtıcı
③	Single duct & radiator	Einkanal & Radiatorventil	Monogaine & radiateur	Monocondotto & radiatori	Un conducto & radiadores	Eénkanaals + radiator	Tek kanal & radyatör
④	Single duct & heating / cooling	Einkanal & Heizen / Kühlen	Monogaine & chauffage / refroidissement	Monocondotto & riscaldamento / raffreddamento	Un conducto & calefacción / refrigeración	Eénkanaals + verwarmen / koelen	Tek kanal & ısıtma soğutma bataryası