

de	Montageanleitung
en	Mounting instructions
fr	Instructions de montage
sv	Monteringsinstruktion
nl	Montagehandleiding
it	Istruzioni di montaggio
fi	Asennusohje
es	Instrucciones de montaje
da	Monteringsvejledning
pl	Instrukcja montażu
cz	Montážní návod
el	Οδηγίες εγκατάστασης
ru	Инструкция по установке
zh	安裝指導

Kugelhahn
Ball valve
Vanne à boisseau sphérique
Kulventilen
Kogelafsluiter
Valvola a sfera
Palloventtiiliin
Válvula de bola
Kulventil
Zawory kulowe regulacyjne
Regulační kulové kohouty
Δίοδες σφαιρικές βάνες
Шаровые клапаны
电动球阀

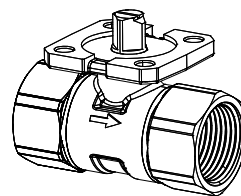

VAI61..

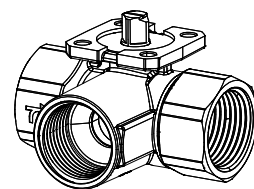

VBI61..

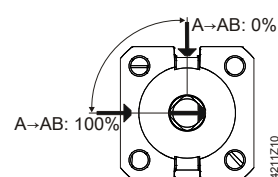
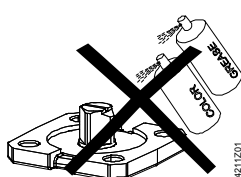
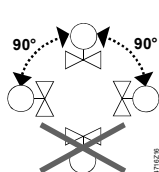

1

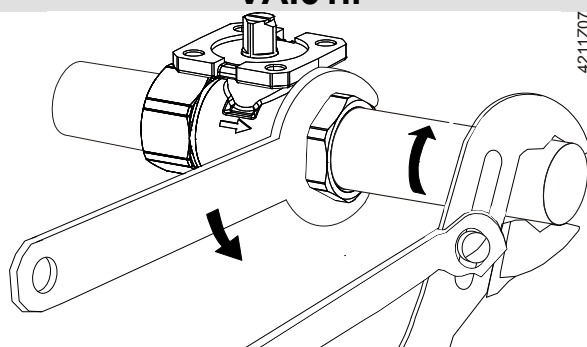

4211Z07

VBI61..

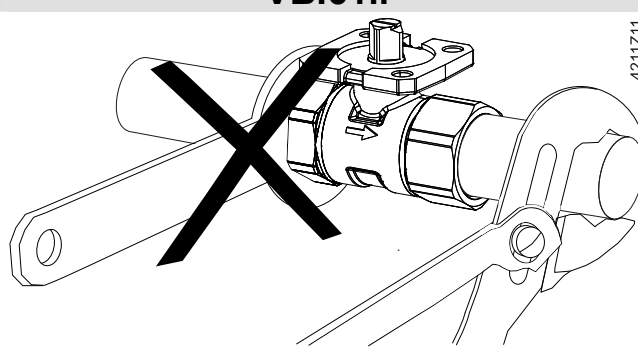

4211Z11

2

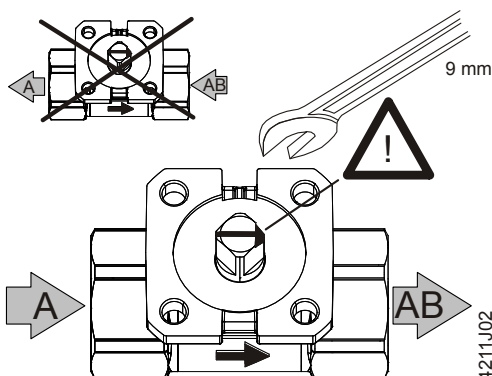

4211J02

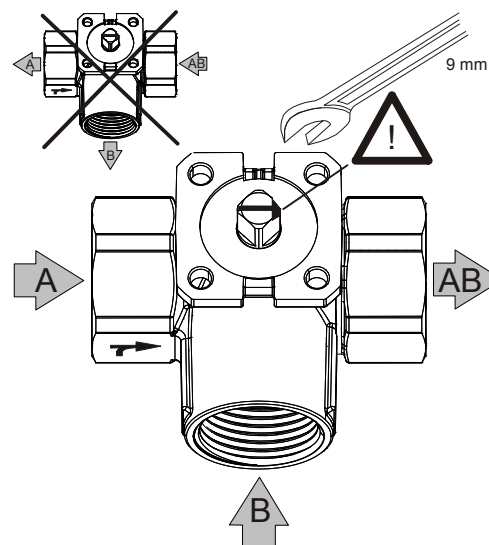

4211J07



A → AB = 100 %



A → AB = 0 %



A → AB = 100 %
B → AB = 0 %



A → AB = 0 %
B → AB = 100 %

3

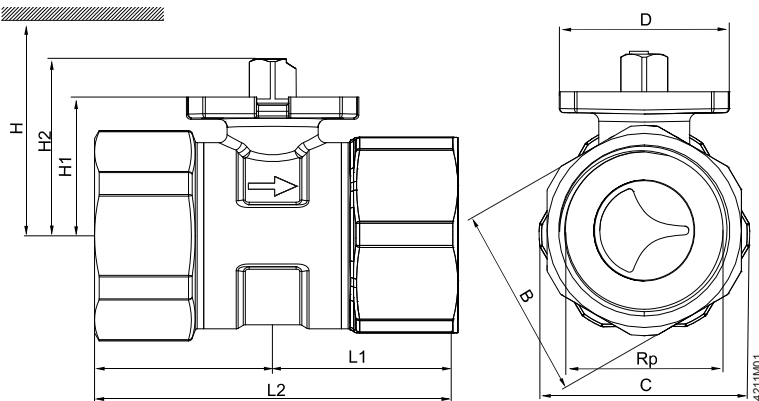
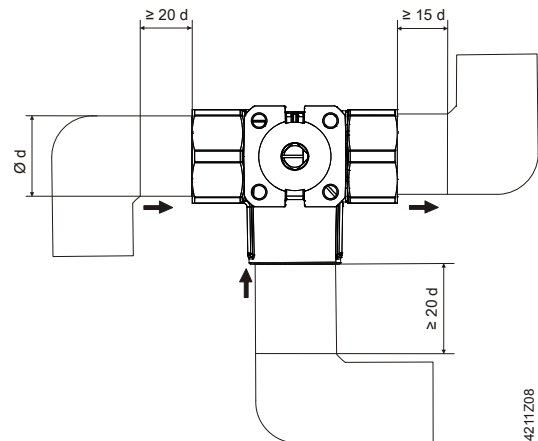
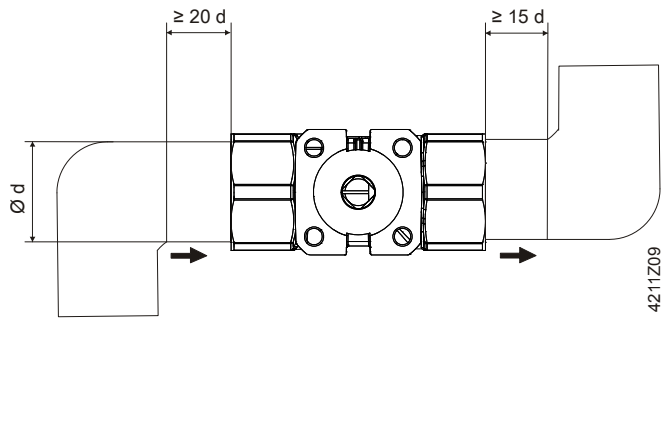

Type	DN	B	C	D	Rp	L1	L2	H1	H2	H				kg
										GQD..9A	GDB..9E	GMA..9E	GLB..9E	
		[mm]	[mm]	[mm]	[Inch]	[mm]	[mm]	[mm]	[mm]	[mm]	[mm]	[mm]	[mm]	[kg]
VAI61.15..	15	26	31 ¹⁾	42	Rp ½	31	62	27.6	37.6	> 300	> 310	>300	>300	0.3
VAI61.20..	20	31	34	42	Rp ¾	33	68	27.6	37.6			>300	>300	0.35
VAI61.25..	25	39	42.5	42	Rp 1	38.5	77	30.5	40.5			>310	>310	0.5
VAI61.32..	32	48	52	42	Rp 1¼	44	88	34.3	44.3			>310	>310	0.7
VAI61.40..	40	55	61	42	Rp 1½	48.5	102	39.8	49.8			>320	>320	1.1
VAI61.50..	50	67	74	42	Rp 2	56.5	119	52.8	62.8			>335	>335	1.8

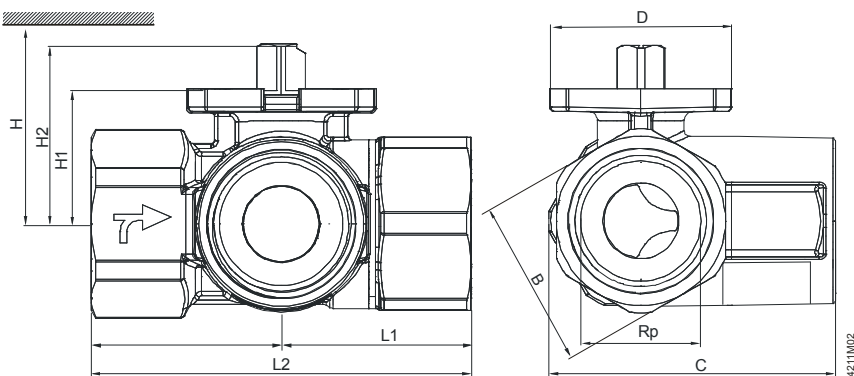

Type	DN	B	C	D	Rp	L1	L2	H1	H2	H				kg
										GQD..9A	GDB..9E	GMA..9E	GLB..9E	
		[mm]	[mm]	[mm]	[Inch]	[mm]	[mm]	[mm]	[mm]	[mm]	[mm]	[mm]	[mm]	[kg]
VBI61.15..	15	26	48.5	42	Rp ½	33.5	67	24.2	33.7	> 300	> 310	>300	>300	0.29
VBI61.15-6.3			49.5	42				27.6	37.6					0.305
VBI61.20..	20	31	52	42	Rp ¾	36	72	27.6	37.6			>310	>310	0.375
VBI61.25..	25	39	64.5	42	Rp 1	42.5	85	30.5	40.5					0.605
VBI61.32..	32	48	76.5	42	Rp 1¼	49.5	99	34.3	44.3			>320	>320	0.95
VBI61.40..	40	55	84.5	42	Rp 1½	55	110	39.8	49.8			>320	>320	1.365
VBI61.50..	50	67	102.5	42	Rp 2	65.5	131	52.8	62.8			>335	>335	2.215